

CEDAR STREET

WARREN STREET

CEAR STREET

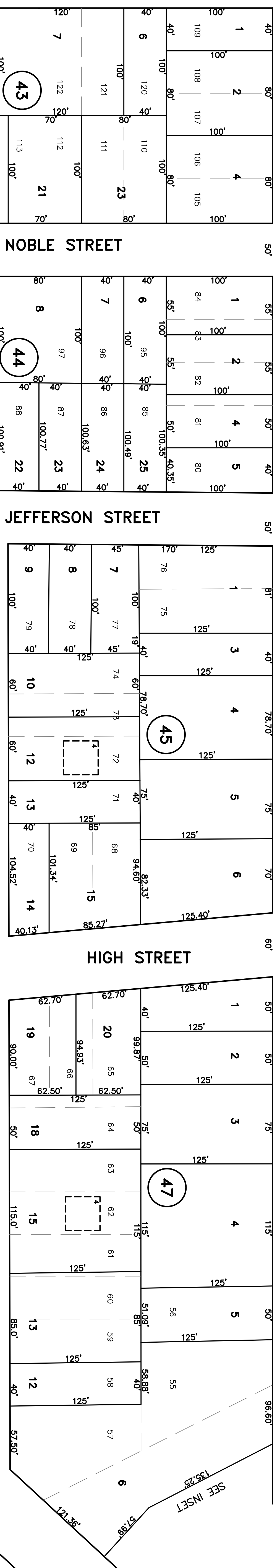

SHEET No 12

SHEET No 16

MAPLE AVE.

MONTGOMERY STREET

SHEET No 14

MAIN STREET

WARREN STREET

CEAR STREET

SHEET No 11

THIS TAX MAP SHEET IS A SCANNED COPY OF THE MAP PREPARED BY C.J. KUPPER, C.E., DATED 1946 AND REVISED THROUGH JULY 1998. THE ORIGINAL TRACINGS ARE FILED IN THE ENGINEER'S OFFICE.

REVISIONS

DATE	NAME	NO.
DECEMBER, 1938	NOT KNOWN	---
JUNE, 1989	HERBERT A. LAUTERWALD, JR., P.E. & L.S.	20890
SEPTEMBER, 1991	HERBERT A. LAUTERWALD, JR., P.E. & L.S.	20890
APRIL 30, 2006	THOMAS J. HERITS, P.E. & P.L.S.	23782
OCT. 6, 2006	THOMAS J. HERITS, P.E. & P.L.S.	23782
JUNE 15, 2007	THOMAS J. HERITS, P.E. & P.L.S.	23782

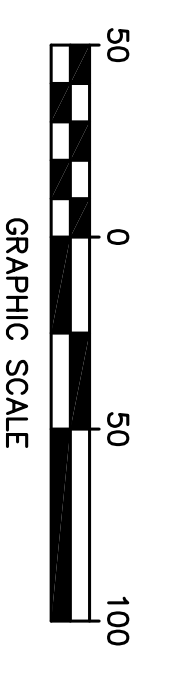

**TAX MAP**  
**BOROUGH OF**  
**SOUTH BOUND BROOK**  
**SOMERSET COUNTY, NEW JERSEY**

NEW JERSEY DEPARTMENT OF TAXATION AND FINANCE  
APPROVED AS A TAX MAP PURSUANT TO THE PROVISIONS OF CHAPTER 175, LAWS OF 1913, ETC.  
FRANK E. WALSH  
DIRECTOR, DIVISION OF TAXATION  
BY THOMAS L. FRYER  
CHIEF ENGINEER AND SUPERVISOR  
DATE: SEPT. 4, 1946 SERIAL NO.: 115

SCALE 1"=50'  
C.J. KUPPER, C.E.  
1946  
TO SHOW CONDITIONS AS OF APRIL 2006